



LAF

Características - Characteristics

Tensión de Alimentación y Consumo 5 V ± 10%, 250 mA
Power Supply and Consumption

Máx. longitud de cable 30 metros
Max. cable length 100 feet

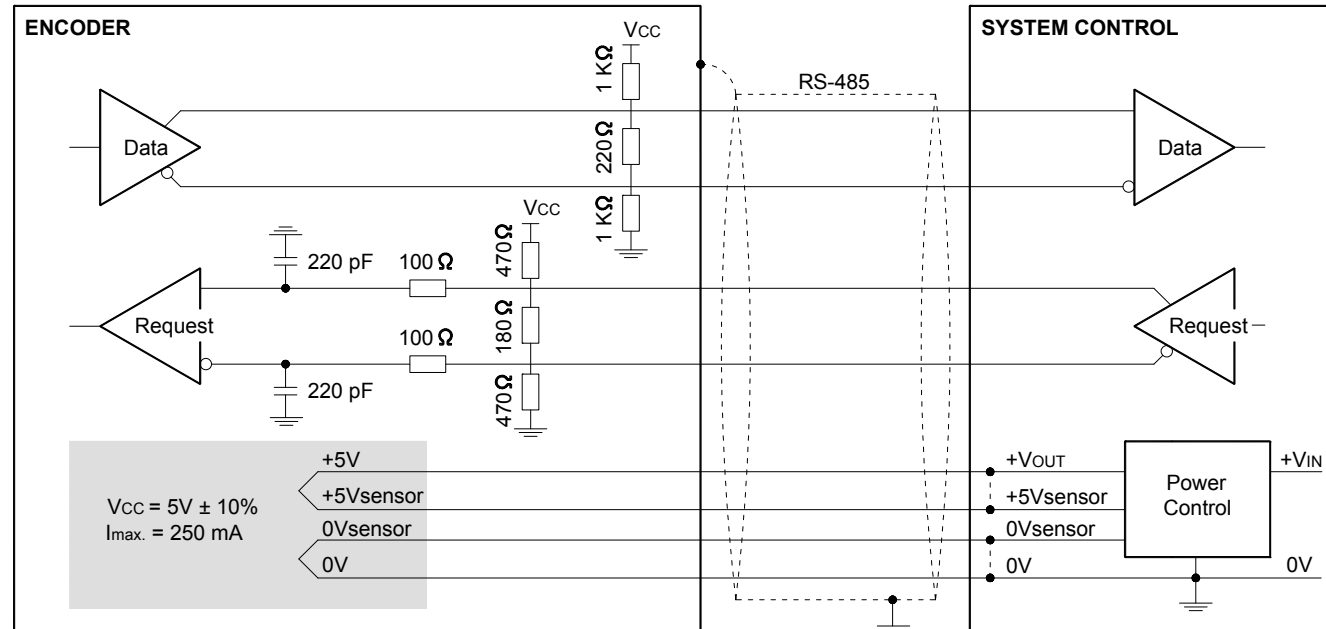

CABLES PARA CONEXION DIRECTA DE ENCODERS FAGOR A SISTEMAS FANUC
CABLES FOR DIRECT CONNECTION OF FAGOR ENCODERS TO FANUC SYSTEMS

HASTA 9 METROS - UP TO 9 METERS

EC - ...PA - FN Conector HONDA / HIROSE hembra para conexión directa a controles absolutos FANUC. En longitudes de 1, 3, 6 y 9 metros.
HONDA / HIROSE female Connector for direct connection to FANUC absolute controllers. Available in 1, 3, 6 and 9 meters.

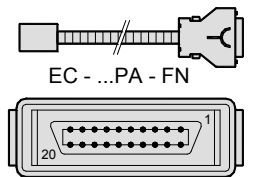

PIN	1	2	5	6	9	18-20	12	14	16
SEÑAL / SIGNAL	Data	/Data	Request	/Request	+5V	+5Vsensor	0V	0Vsensor	Tierra / Ground
COLOR	Verde Green	Amarillo Yellow	Azul Blue	Rojo Red	Marrón Brown	Gris Grey	Blanco White	Rosa Pink	Malla Shield

A PARTIR DE 9 METROS - FROM 9 METERS

* (EC - ...B - C9) + (XC - C8 - ... - FN)

EC - ...B - C9 Conector Circular 17 macho. En longitudes de 1 y 3 metros (otras longitudes consultar a Fagor).
Circular 17 male Connector. Available in 1 and 3 meters (contact Fagor for other lengths).

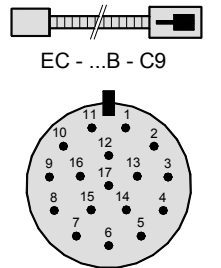

PIN	14	17	8	9	7	1	10	4	Carcasa / Housing
SEÑAL / SIGNAL	Data	/Data	Request	/Request	+5V	+5Vsensor	0V	0Vsensor	Tierra / Ground
COLOR	Gris Gray	Rosa Pink	Negro Black	Violeta Purple	Marrón Brown	Verde Claro Ligth Green	Blanco White	Naranja Orange	Malla Shield

XC - C8 - ... - FN Alargadera con Conector Circular 17 hembra / Conector HONDA / HIROSE hembra. En longitudes de 5, 10, 15, 20 y 25 metros.
Extension Cable with Circular 17 female Connector / HONDA / HIROSE female connector. Available in 5, 10, 15, 20 and 25 meters.

[4x2x0.14mm² + 4x0.5mm²]

PIN	14	17	8	9	7	1	10	4	Carcasa / Housing
PIN	1	2	5	6	9	18-20	12	14	16
SEÑAL / SIGNAL	Data	/Data	Request	/Request	+5V	+5Vsensor	0V	0Vsensor	Tierra / Ground
COLOR	Gris Gray	Rosa Pink	Violeta Purple	Amarillo Yellow	Marrón-Verde Brown-Green	Azul Blue	Blanco-Verde White-Green	Blanco White	Malla Shield

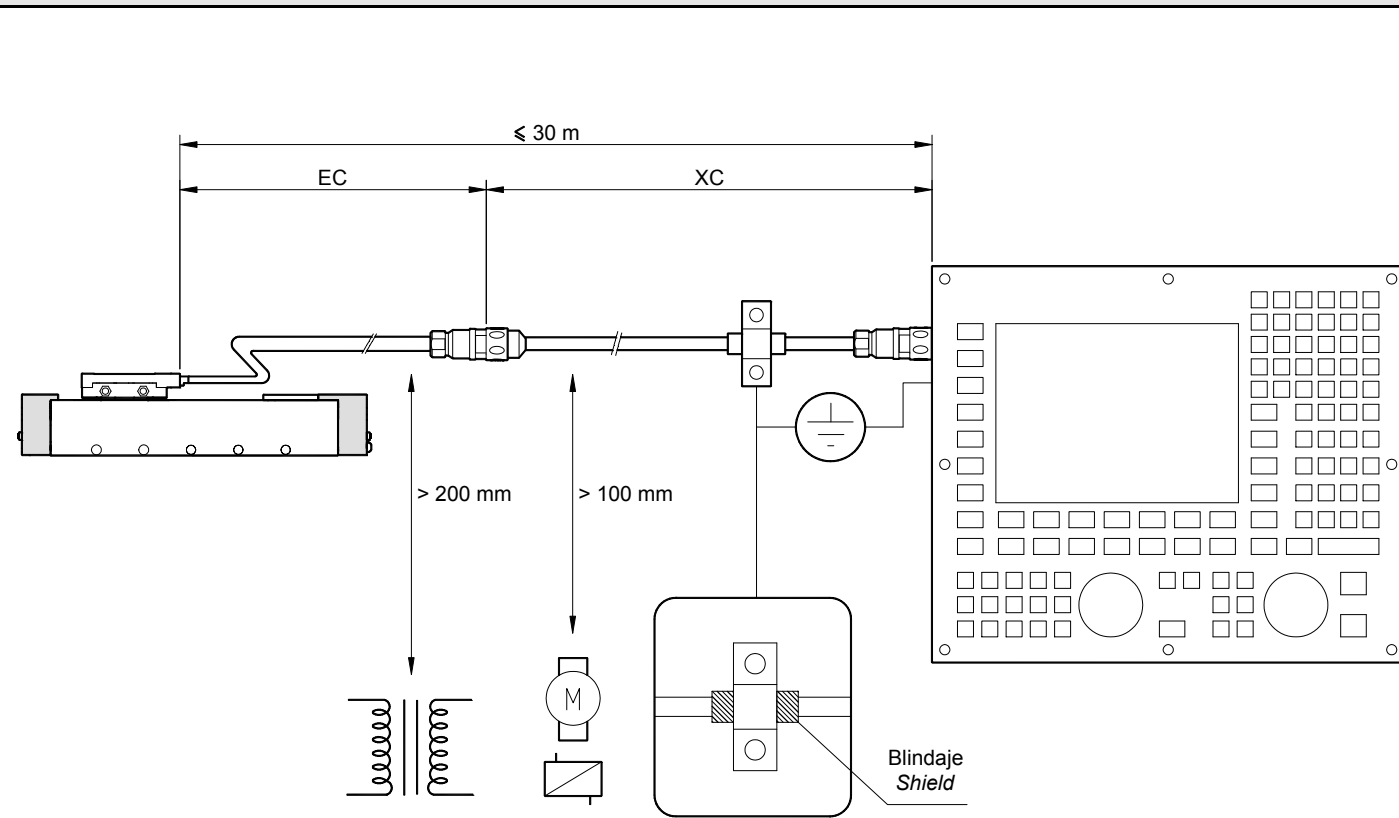
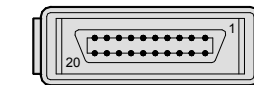
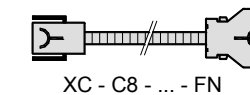
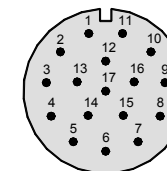

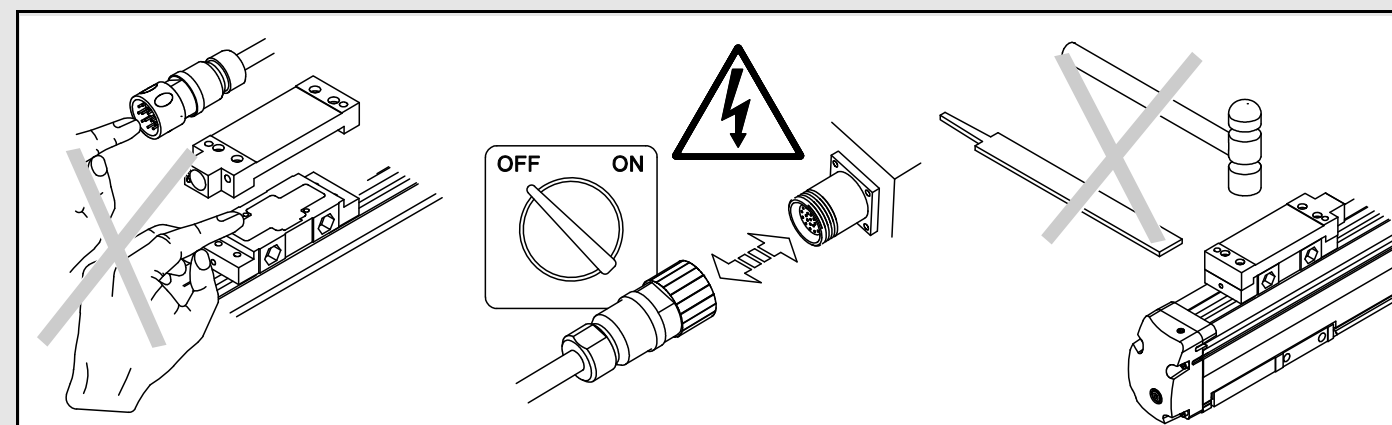

Es posible orientar la salida del conector a ambos lados.
The connector exit may be oriented at both ends.

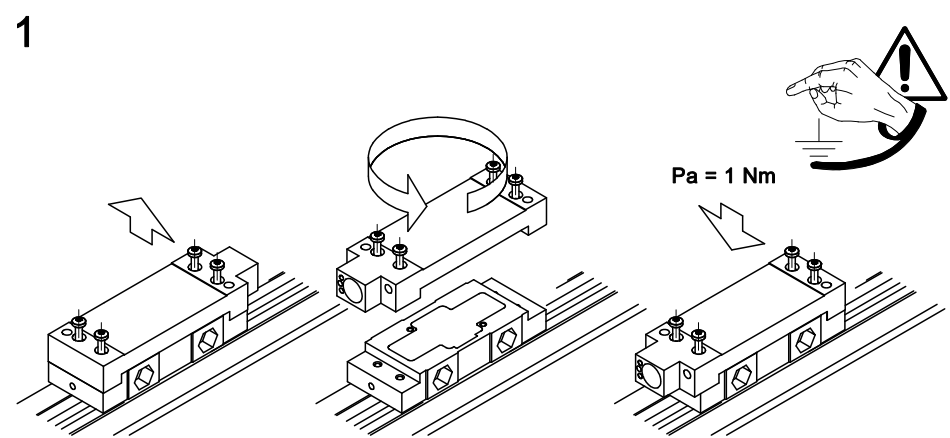

Introducir la cabeza por cualquiera de los dos extremos de la regla.
Insert the reader head through any of the two ends of the scale.

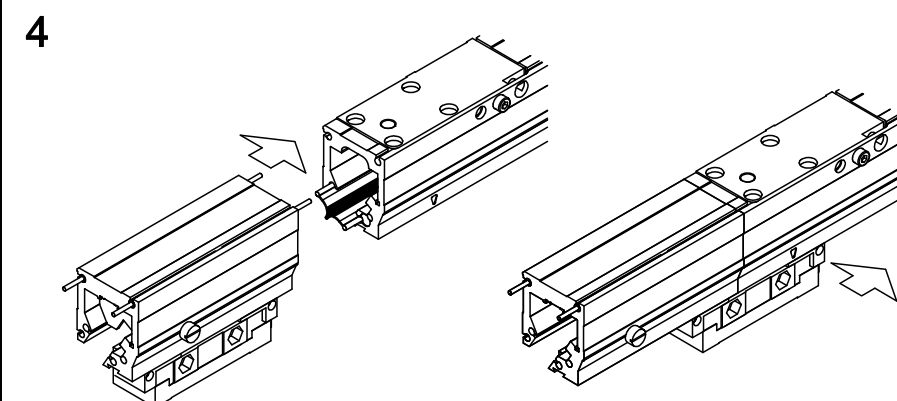

Quitar las tapas.
Remove the end caps.

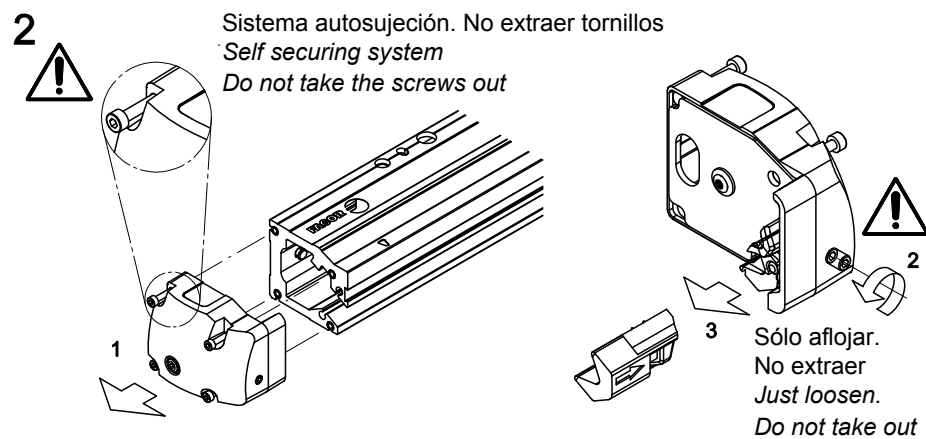

Fijar la cabeza lectora.
 Los soportes fijan la distancia de separación (2.5 mm) entre la cabeza y la regla.
 Quitar los soportes de la cabeza.
Secure the reader head. The supports set the 2.5 mm gap between the reader head and the scale. Remove the reader head supports.

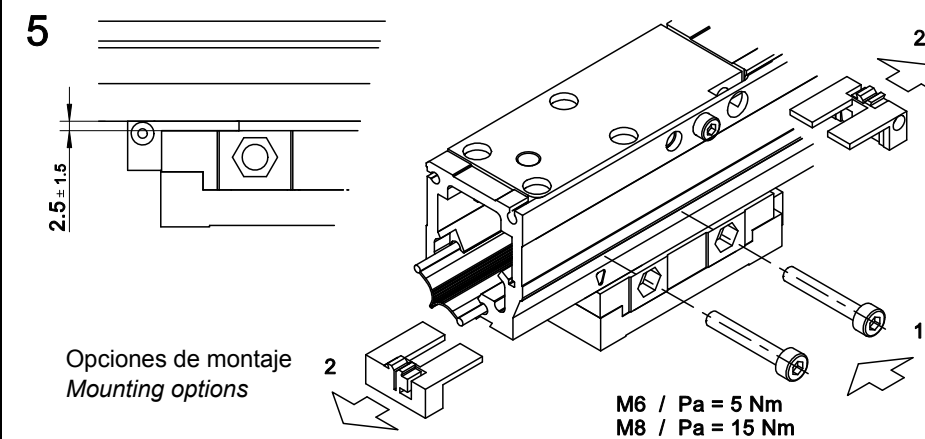

Aflojar los tornillos del embalaje de la cabeza.
Loosen the packing screws of the reader head.

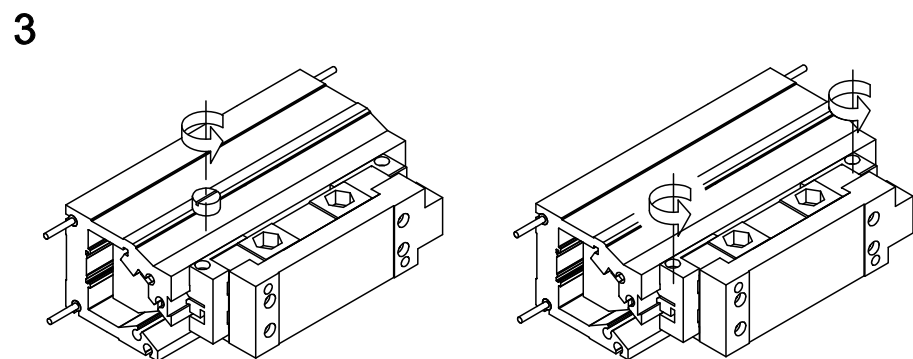

Poner las tapas.
Mount the end caps.

